

REVISION HISTORY		
REV.	DESCRIPTION	DATE
B	CUSTOMER REVISION RELEASE	5/6/2014

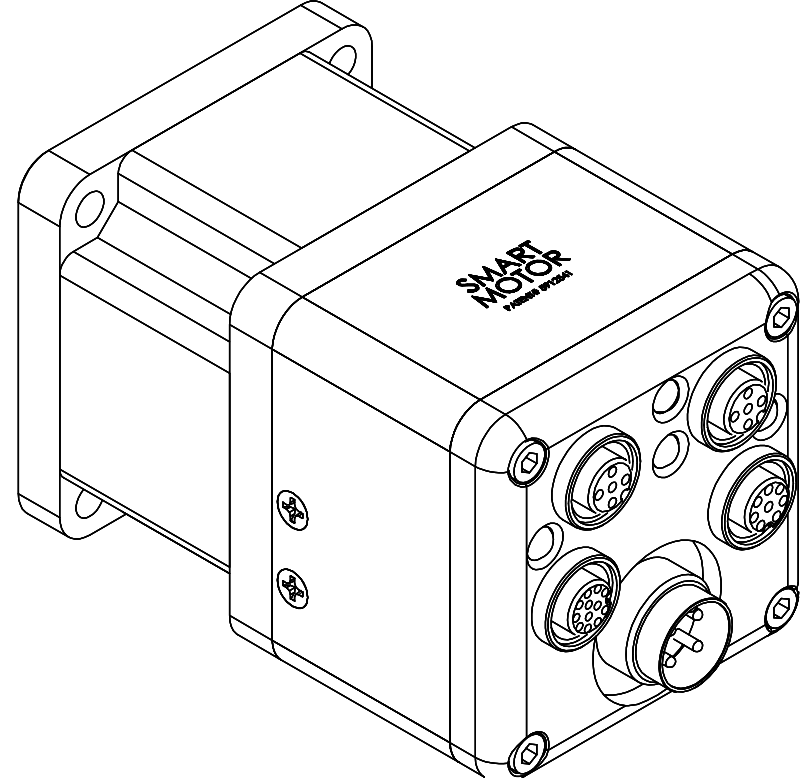

$\phi .21 [5.21]$ THRU
ON $2.63 [66.7]$ DIA B.C.
EQUALLY SPACED

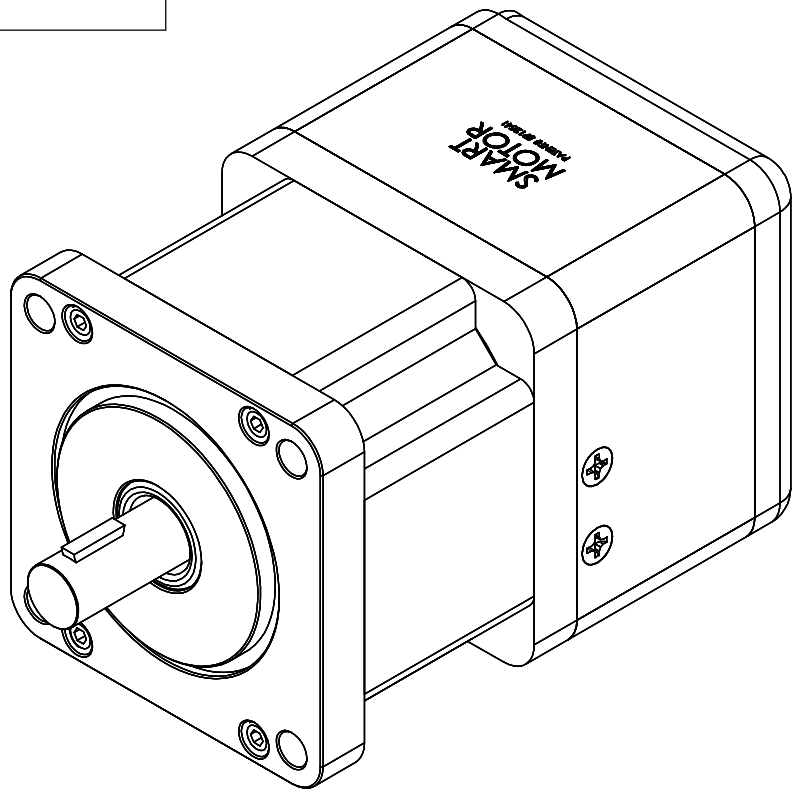
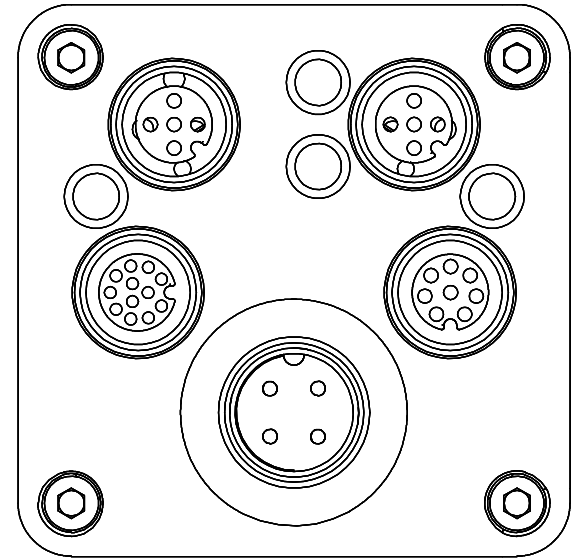
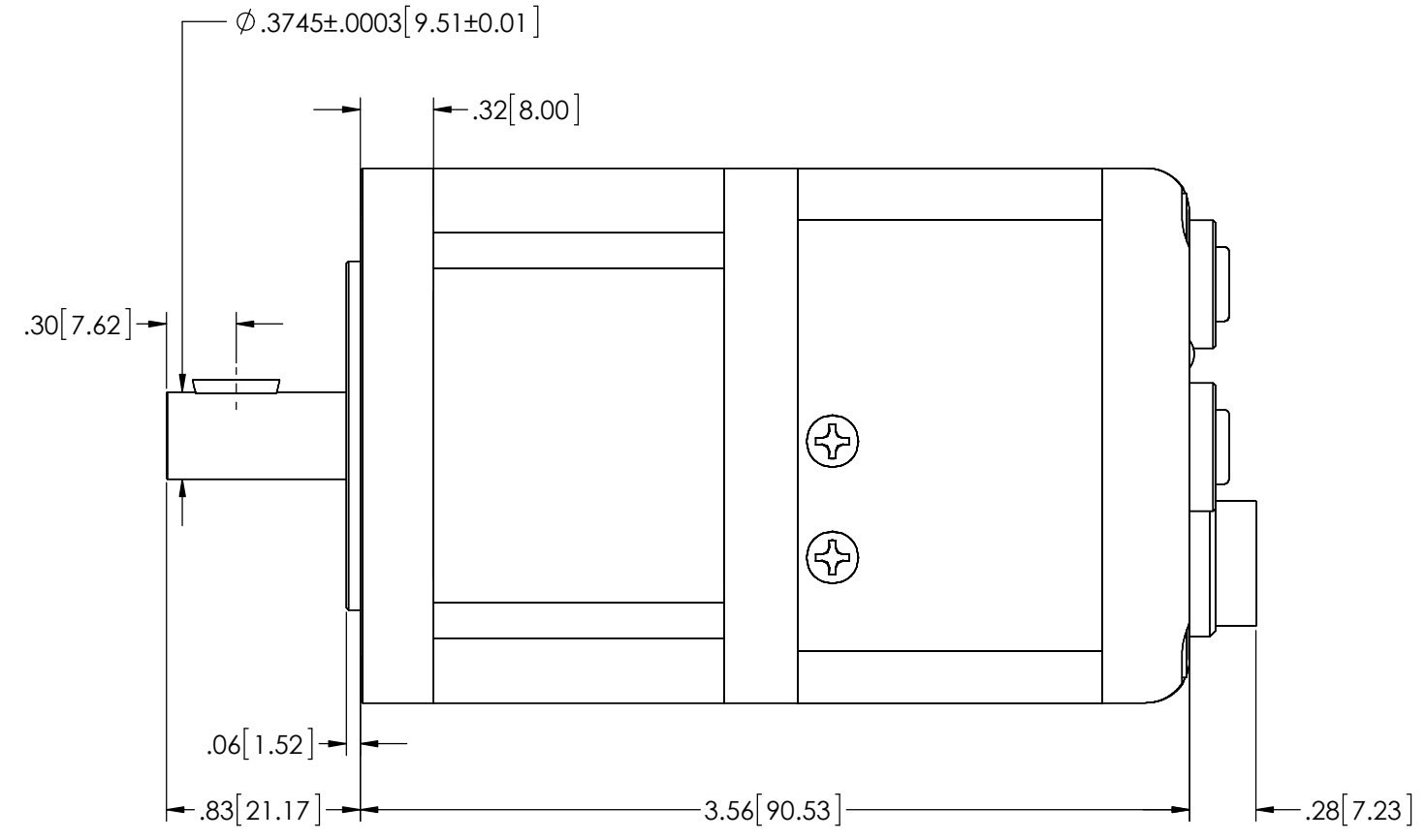
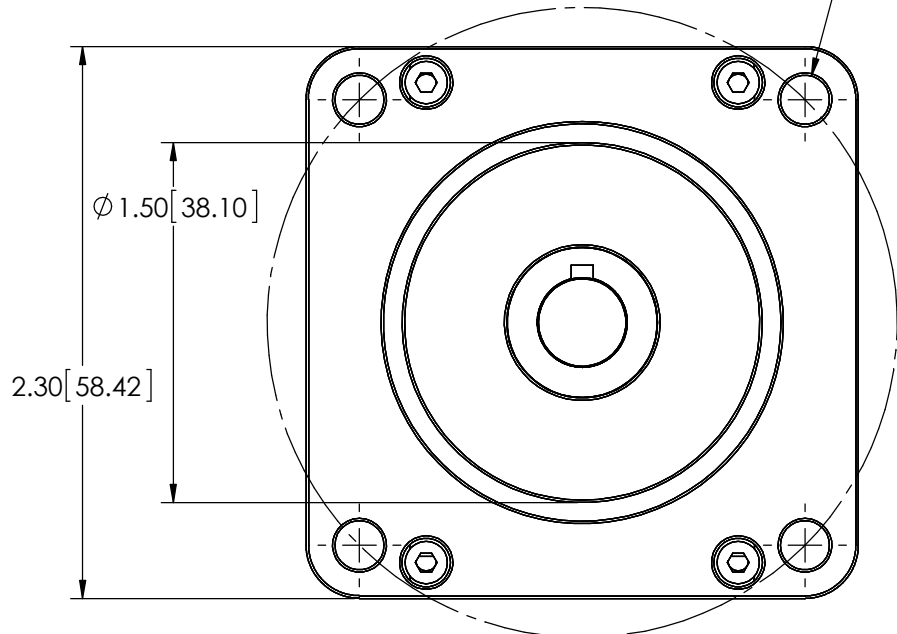

NOTES, UNLESS OTHERWISE STATED:
 1. WOODRUFF ANSI 303 KEY IS USED ON THE SHAFT.
 2. CONSULT FACTORY IF GREATER TOLERANCE DETAILS ARE NEEDED.
 3. DIMENSIONS SUBJECT TO CHANGE.

UNLESS OTHERWISE SPECIFIED DIMENSIONS ARE IN INCHES		CAD GENERATED DRAWING DO NOT MANUALLY UPDATE		 1421 McCarthy Ave. Milpitas, CA. 95035	
APPROVALS	DATE	APPROVALS	DATE	TITLE	
	5/6/2014		5/6/2014	SM2316, HI TQ, M, CI5, CAN, 24V I/O, IP65	
DRAWN		CHECKED		SIZE	REV
ENGR		ENGR		D	B
MFG ENGR		SHOP ENGR		CAGE CODE	
QA		QA		4H618	SM23165MT-IP
				SCALE	SHEET 1 OF 1
				5:2	SM23165MT-IP