

DIMENSION "L"

Single Stage (3:1 to 10:1) = 4.063 ± .015
Double Stage (16:1 to 100:1) = 5.431 ± .015

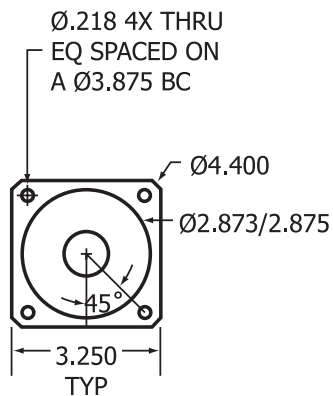

NOTE: Dimensions in inches

Part #	Ratio	Continuous output torque at 1500 rpm input (in-lbs)	Continuous output torque at 3500 rpm input (in-lbs)	Continuous output torque at 5000 rpm input (in-lbs)	Gearhead inertia at input (lb-in-sec ²)
Single Stage					
GH34RAP3	3:1	525	525	475	1.20 x 10 ⁻³
GH34RAP5.5	5.5:1	525	525	525	3.08 x 10 ⁻⁴
GH34RAP10	10:1	525	525	505	1.26 x 10 ⁻⁴
Double Stage					
GH34RAP16	16:1	656	656	656	3.05 x 10 ⁻⁴
GH34RAP22	22:1	656	656	656	1.65 x 10 ⁻⁴
GH34RAP55	55:1	656	656	656	8.10 x 10 ⁻⁵
GH34RAP100	100:1	656	656	656	7.92 x 10 ⁻⁵

⚠ WARNING - Please read when using with SM3416DT-PLS2 Series Motor:

All gearheads above come standard with 3/8 inch diameter input shaft. For gearheads which require 0.5 inch shaft input, please add "-0.5" to part number. Example: GH34RAP3-0.5 will give you a half inch input shaft diameter.

Construction Type	Ratio	Standard Backlash (arc-minutes)	Low Backlash (arc-minutes)	Efficiency	Weight (lbs)	Maximum Tested Input rpm
Single Stage	3:1 to 10:1	10	7	90%	11.89	5000
Double Stage	16:1 to 100:1	14	11	85%	14.62	5000

PEAK TORQUE: 15% above continuous rating. **NOTE:** Repeated peak torque loading may cause failure.