

REV.	DESCRIPTION	ZONE	ECO	DATE	APPROVED
1	DRAWING RELEASE			04/29/2009	M. TRAN

NOTES:

- DRAWING APPLIES TO THE FOLLOWING SMARTMOTOR WITH PART NUMBERS:

SM2315D-BRK	SM2315D-DEBRK	SM2315DT-BRK	SM2315DT-DEBRK
SM2316D-BRKPLS2	SM2316D-BRKDEPLS2	SM2316DT-BRKPLS2	SM2316DT-BRKDEPLS2
SM23165D-BRK	SM23165D-BRKDE	SM23165DT-BRK	SM23165DT-BRKDE
- LED, SERVO-AMPLIFIER:
 - FOR SM2315D AND SM2316D
 - CLEAR = CONTROLLER POWER NOT AVAILABLE
 - RED = DRIVE (AMPLIFIER) IS OFF
 - GREEN = DRIVE (AMPLIFIER) IS ON
 - FOR SM23165D
 - CLEAR = CONTROLLER POWER NOT AVAILABLE
 - RED = FAULT
 - FLASH GREEN = DRIVE (AMPLIFIER) IS OFF
 - GREEN = DRIVE (AMPLIFIER) IS ON
- LED, TRAJECTORY
 - CLEAR = NOT IN CONTROLLED TRAJECTORY (DEFAULT STATE)
 - GREEN = IN CONTROLLED TRAJECTORY (CLOSE LOOP MOTION)
- FOR -DE OPTION, DRIVE POWER AND CONTROLLER POWER ARE ON SEPARATE PINS. MUST PROVIDE POWER TO CONTROLLER AND DRIVE POWER TO OPERATE. SEE TABLE CN2 BELOW FOR PIN ASSIGNMENT.
- DIMENSIONS IN [] ARE mm.
- RECOMMENDED BOLTING SCREW SIZE TO BE 10-32 OR M5x0.8.

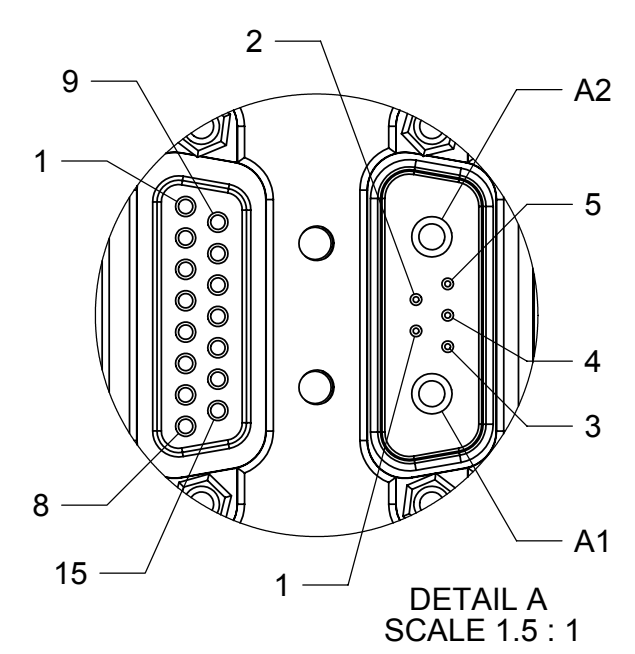
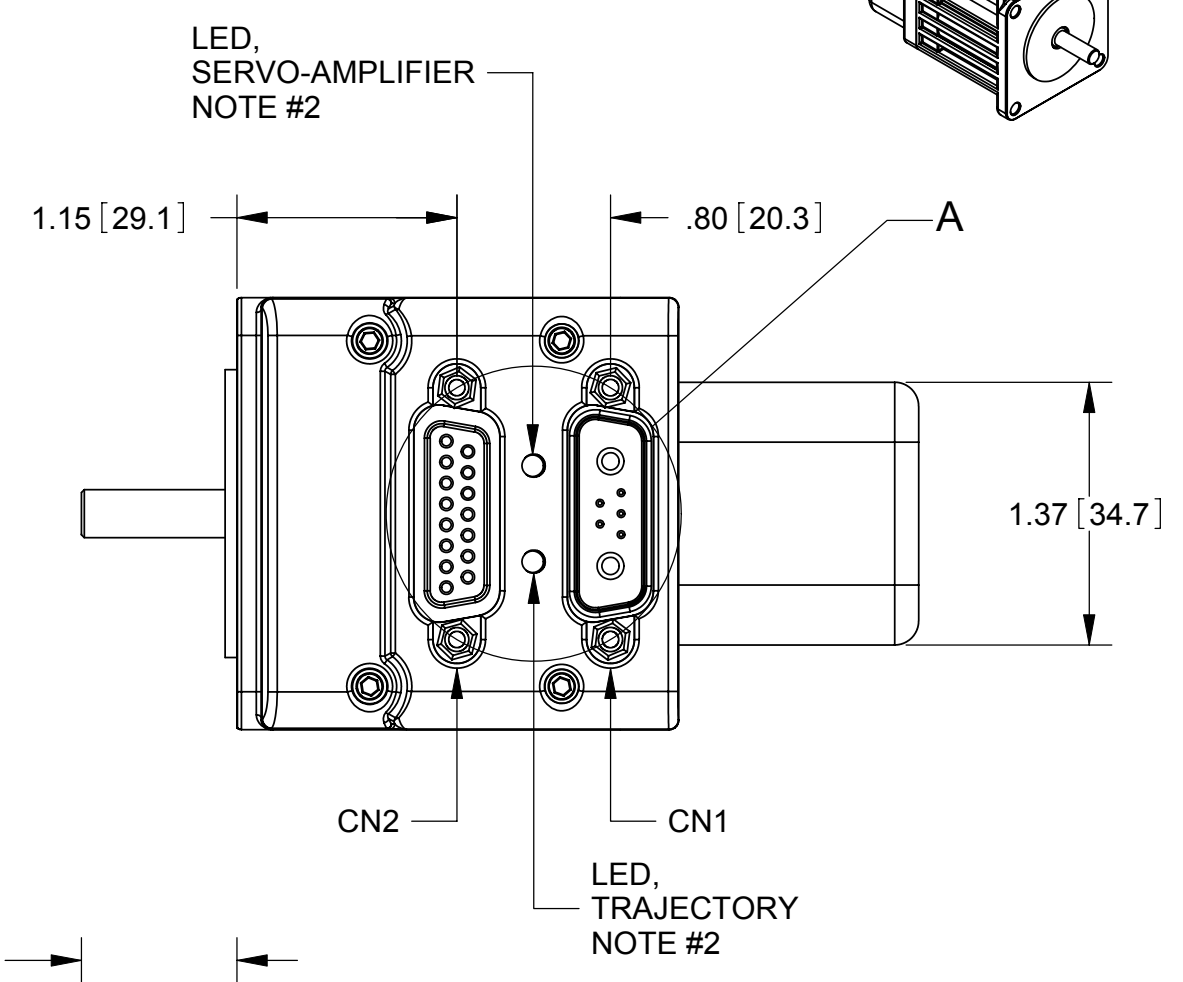
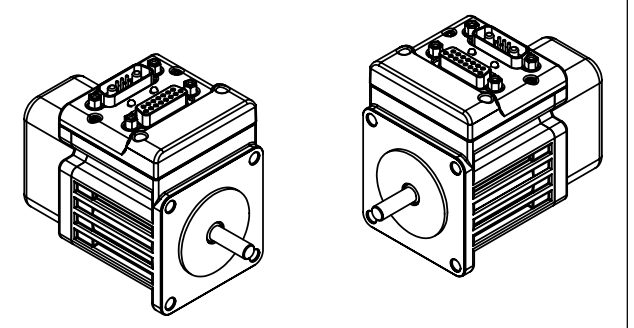

Ø.20 [5.0] THRU
ON Ø2.625 [66.68] B.C.
EQUALLY SPACED

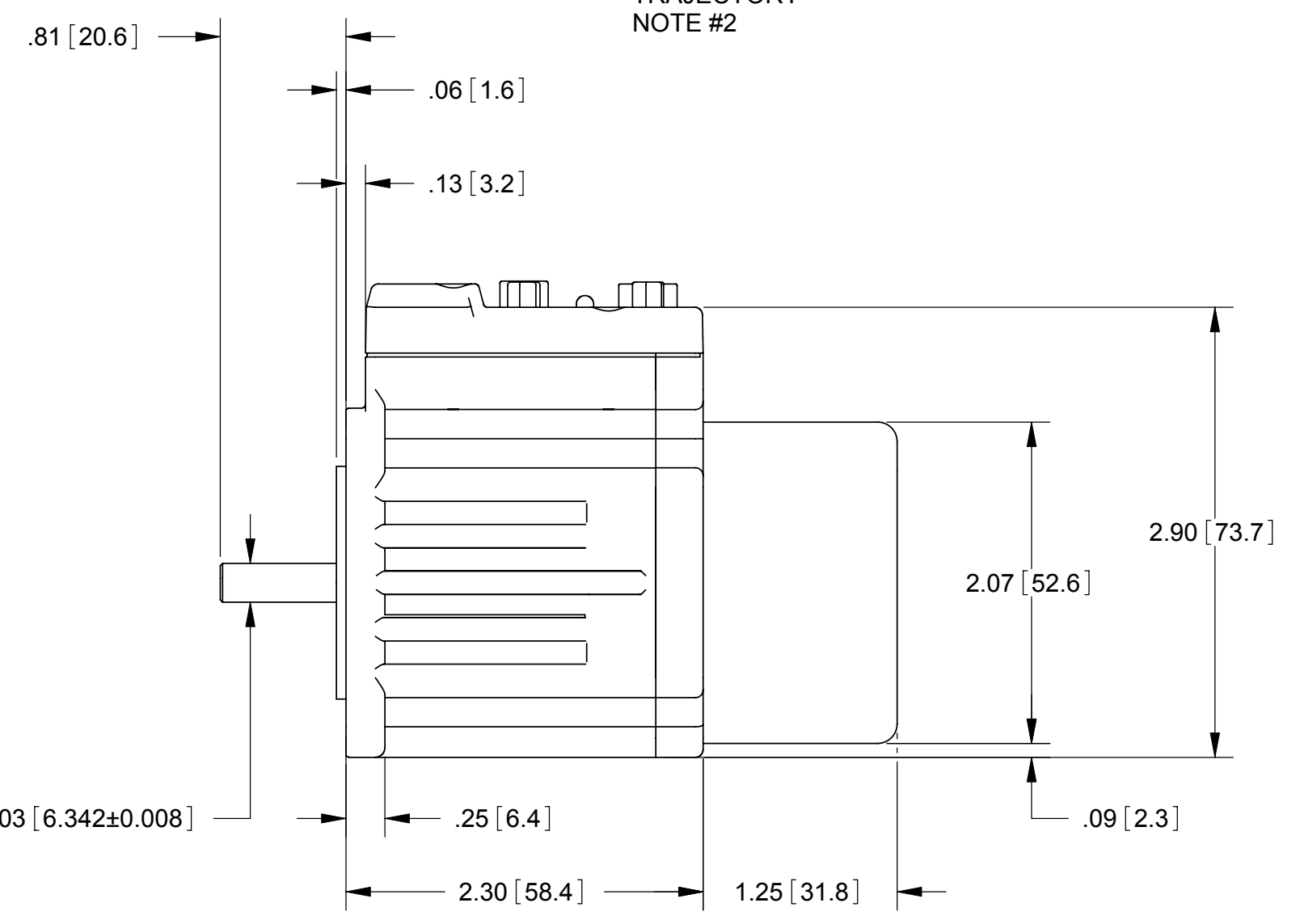
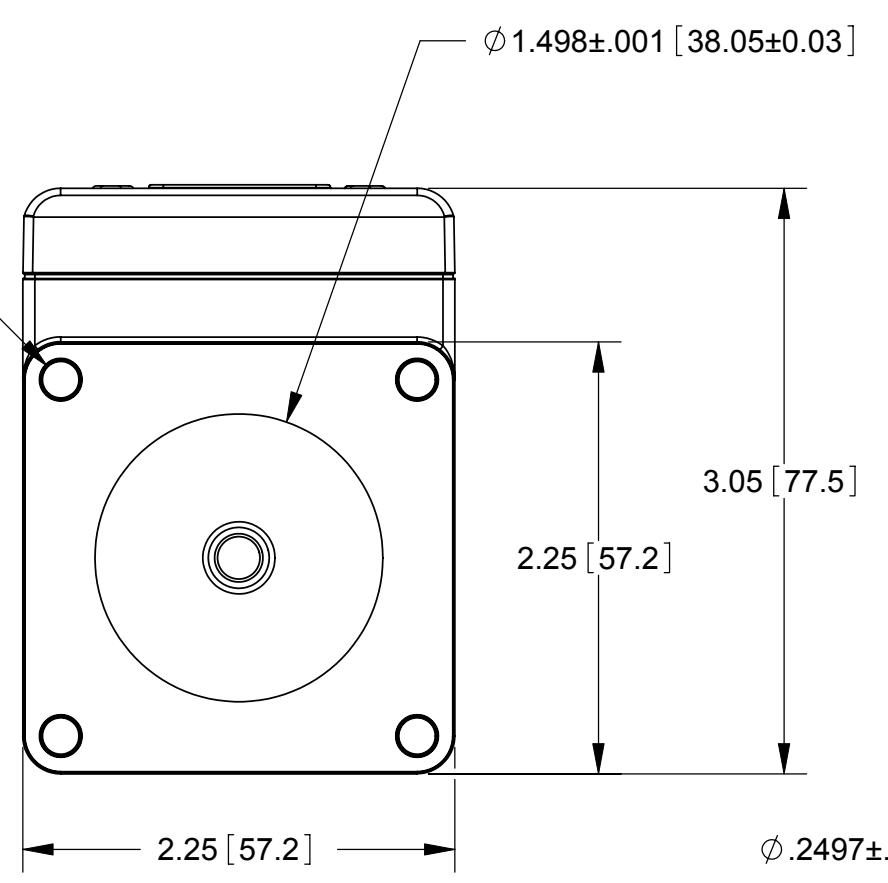

CN2 : 15PIN D-SUB FEMALE CONNECTOR					
PIN #	NAME	FUNCTIONS			
		Default Function	Secondary Function	Digital I/O	Analog Input (10bit Res)
1	I/O A	External Encoder A Input	Step Input	5V TTL	0 to 5V
2	I/O B	External Encoder B Input	Direction Input	5V TTL	0 to 5V
3	I/O C	Positive Limit Input		5V TTL	0 to 5V
4	I/O D	Negative Limit Input		5V TTL	0 to 5V
5	I/O E	AniLink Data -	RS485 A (+) *	5V TTL	0 to 5V
6	I/O F	AniLink Clock -	RS485 B (-) *	5V TTL	0 to 5V
7	I/O G	G-Synchronization	RS485-ISO Adaptor Flow Control	5V TTL	0 to 5V
8	ENC A OUT	Encoder A Output			
9	ENC B OUT	Encoder B Output			
10	RS232 Tx	RS232 Transmit			
11	RS232 Rx	RS232 Receive			
12	+5Vdc OUT	+5Vdc Output			
13	GND	Signal GND			
14	POWER GND	POWER GND	For -DE Option, Pin 15 is Controller power (20V to 48V) and Pin 14 is PWR GND. *PIN 15 is not connected to A1.		
15	POWER	POWER			

CN1 : 7PIN COMBO D-Sub Male Connector				
PIN #	NAME	FUNCTIONS	Ties to CN2, PIN #	
1	I/O G	G-Synchronization	7	
2	+5V dc OUT	+5Vdc Output	12	
3	RS232 Tx	RS232 Transmit	10	
4	RS232 Rx	RS232 Received	11	
5	GND	Signal GND	13	
A1	DRIVE PWR	Drive Power (20 - 48Vdc)	15^	
A2	POWER GND	POWER GND	14	

CONFIDENTIAL. THE INFORMATION CONTAINED HEREIN IS THE PROPRIETY PROPERTY OF ANIMATICS CORPORATION AND IS PROTECTED AS A TRADE SECRET. IT IS SUBMITTED FOR USE BY RECIPIENT ONLY FOR A BUSINESS PURPOSE AUTHORIZED BY ANIMATICS CORPORATION. ANY OTHER USE IS PROHIBITED. RECIPIENT AGREES TO KEEP SUCH INFORMATION CONFIDENTIAL.

MATERIAL ALUMINUM HOUSING	FINISH BLACK ANODIZED HOUSING	DRAWN M. TRAN	DATE 4/23/2009
		ENGR M. TRAN	DATE 4/23/2009

INCH
THIRD ANGLE PROJECTION

UNLESS OTHERWISE SPECIFIED:
DIMENSIONS ARE INCHES AND TOLERANCES ARE:
DECIMALS: .XXX ± .005
.XX ± .01
ANGLES: .XX ± 0.25°
.X ± 0.5°

INTERPRET DIMENSIONS AND TOLERANCES PER ASME Y14.5M - 1994.
ALL DIMENSIONS, TOLERANCES AND ROUGHNESS APPLY AFTER FINISHING, WHEN APPLICABLE.
NO BURRS ALLOWED, BREAK SHARP EDGES .01 MAX.

Animatics Corporation

TITLE: **SM2315D, SM2316D, AND SM23165D SERIES WITH BRAKE OPTION**

SIZE C	DWG NO SM2315D SM2316D SM23165D BRAKE
DO NOT SCALE DRAWING	SCALE 1:1 SHEET 1 OF 1